

EQUILIBRIUM FLOAT VALVES, E404

Envotec Equilibrium Float Valves E404 mechanical type are designed to control the level of water within a storage tank or reservoir. The modulation of float valve is due to fluctuation of water level in storage tank or reservoir and then opening or closing the float valve in response to it.

FEATURES 2-1/2 "

- All bronze body construction
- Stainless steel connecting Stem
- High grade copper float. Firmly bonded overlapping joints (lead free solder)
- High tensile manganese bronze long arm
- No jam single plunger action shut off
- Replaceable seals
- Configured to flanged end connection
- Smoothly controlled closure ensures a quiet

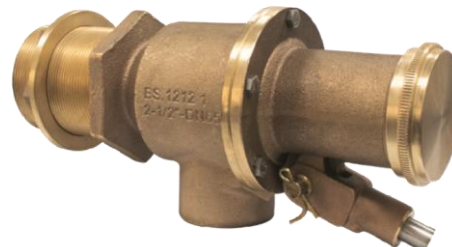

PRESSURE & TEMPERATURE MATERIAL LIST

- **Max. Working Pressure:** 232 psi (16 bar)
- **Max. Working Temperature:** 180 °F (82.2°C)

APPLICATION

Used in residential, commercial, industrial, and irrigation applications.

END CONNECTIONS

- Male Threaded BSPT W/ Backnut (Standard)
- Flanged End (Optional)

ITEM	DESCRIPTION	MATERIAL
1	Body	Bronze
2	Plunger	Bronze
3	Long arm	Bronze
4	Cap	Bronze
5	Plunger tip	Buna-N
6	O-ring	EPDM
7	Bolts	SS304
	Shackle Bolt/Washer	Bronze
	Cotter pin	Brass
9	Stem	Stainless Steel (2 1/2"-4") Brass (6")
10	Float	Copper
11	Backnut	Bronze
12	Flange (if equipped)	Stainless Steel 316

EQUILIBRIUM FLOAT VALVES, E404

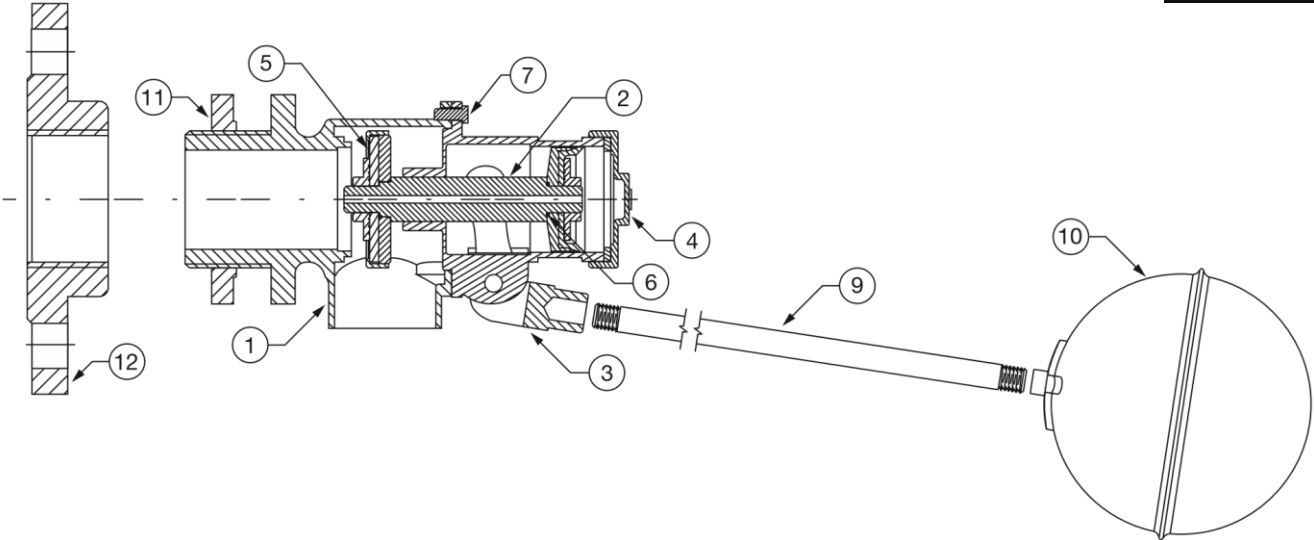

EQUILIBRIUM FLOAT VALVES, E404
v3.1E4040620

FLOW CURVE

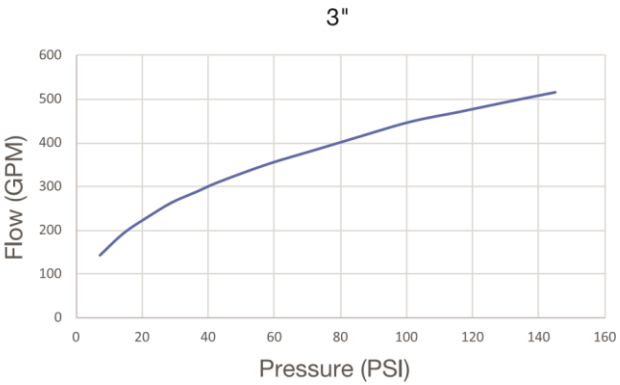
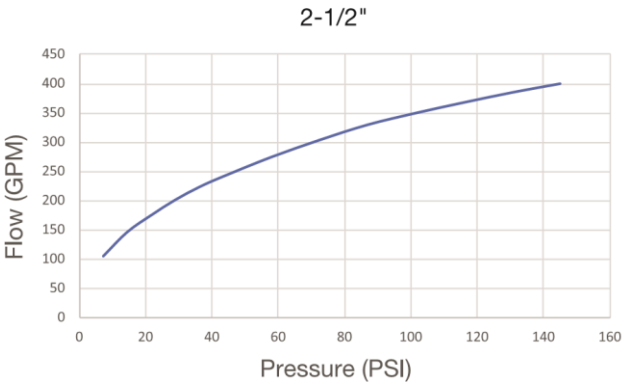

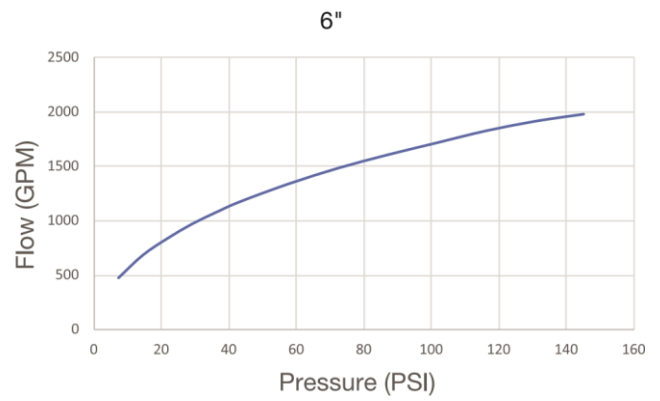
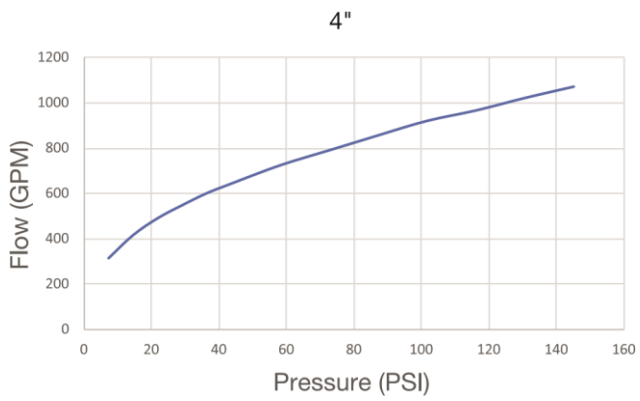

TYPICAL INSTALLATION

Type -A (Threaded)

Type -B (Flanged)

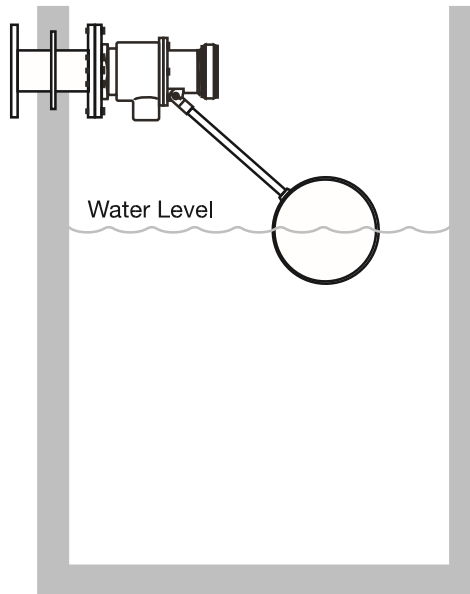
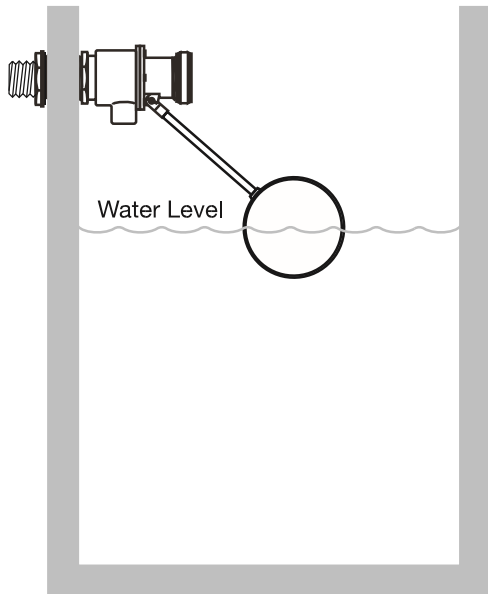

All information contained herein design, construction, specifications, or materials was current at the time of printing. Because of Envotec policy of ongoing research and development, the company reserves the right to discontinue or update product information such changes and modifications on Envotec products previously or subsequently sold without prior notice.