

Mod.

# GMDM

Getto multiplo quadrante asciutto  
*Multi jet-super dry*



mod. GMDX 90°C



Disponibile versione  
acqua calda 30-90°C  
Available version  
for hot water 30-90°C

## ITA mod. GMDM

Getto multiplo, quadrante asciutto, lettura diretta. Realizzato nella versione per acqua fredda (30°C) nei calibri da  $\varnothing$  15 a 50 mm ( $1/2'' \div 2''$ ). Esclusi rischi di corrosione e sedimentazione. Dispositivo antimagnetico a richiesta. Garanzia di lunga durata ed elevata precisione.

## DEU mod. GMDM

Vielfachwasserstrahl, trocken es Zifferblatt, Direktablesung. Produziert in den Versionen Kaltwasser (30°C) in den Durchmessern von 15 bis 50 mm ( $1/2$  Zoll  $\div 2$  Zoll). Die Risiken von Rost und Ablagerungen sind ausgeschlossen. Antimagnetische Vorrichtung auf Anfrage. Garantiert lange Haltbarkeit und erhöhte Genauigkeit.

## ENG mod. GMDM

Multi jet, dry dial, direct reading. Made in the version for cold water (30°C) in the diameters 15 to 50 mm ( $1/2'' \div 2''$ ). Risks of corrosion and sedimentation free. Antimagnetic protection upon request. Long durability and elevated precision guaranteed.

## FRA mod. GMDM

Jets multiples, cadran sec à lecture directe, disponible en la version pour eau froide (30°C) et du calibre 15 au calibre 50 mm (de  $1/2''$  à  $2''$ ), exclus tous problèmes de corrosion et d'incrustation, équipé d'une protection antimagnétique sur demande, fiabilité dans le temps et précision élevée.

## ESP mod. GMDM

Chorro múltiple, esfera seca, lectura directa. Fabricado en la versión para agua fría (30°C) en los calibres de  $\varnothing$  15 a 50 mm ( $1/2'' \div 2''$ ). Libre de riesgos de corrosión y sedimentación. Bajo pedido se suministra con dispositivo antimagnético. Garantía de larga duración y elevada precisión.

## RUS mod. GMDM

Многоструйный счетчик с сухим квадрантом и прямым считыванием. Выпускается в версии для холодной (30°C) воды диаметрами условного прохода от 15 до 50 мм ( $1/2'' - 2''$ ). Исключены риски коррозии и образования осадка. Антимагнитная защита – по запросу. Гарантия долговечности и высокой точности.

### Caratteristiche tecniche - Technical features

Calibro Size	DN	mm in	15 (1/2")	20 (3/4")	25 (1")	32 (1 1/4")	40 (1 1/2")	50 (2")
Portata di sovraccarico Overload flow rate	Q <sub>4</sub>	m <sup>3</sup> /h	3,125	5	7,875	12,5	20	31,25
	Q <sub>3</sub>	m <sup>3</sup> /h	2,5	4	6,3	10	16	25
R = 100 H	Portata di transizione Transitional flow rate	l/h	40	64	100,8	160	256	400
	Portata minima Min flow rate	l/h	25	40	63	100	160	250
R = 160 H	Portata di transizione Transitional flow rate	l/h	25	40	63	100	160	250
	Portata minima Min flow rate	l/h	15,63	25	39,38	62,5	100	156,25
Sensibilità Sensitivity	l/h	l/h	6	6	10	10	20	20
	Lettura minima Min reading	l	0,05	0,05	0,05	0,05	0,05	0,05
	Lettura massima Max reading	m <sup>3</sup>	99.999	99.999	99.999	99.999	999.999	999.999
	Pressione max ammissibile Max admissible pressure MAP	bar	16	16	16	16	16	16

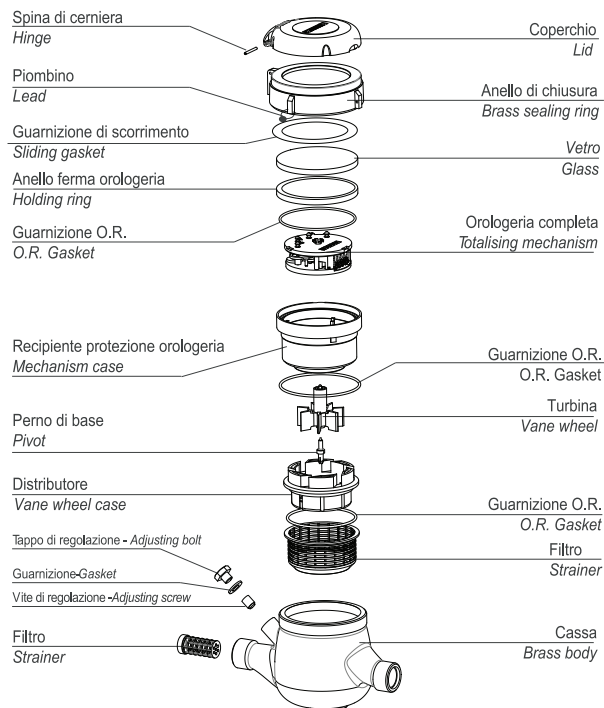

### Posizione d'installazione Installation position

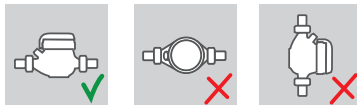

### Dimensioni e pesi - Dimensions and Weights

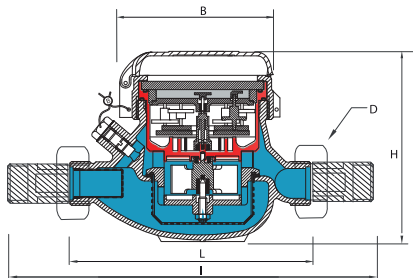

Calibro Size	mm in	15 (1/2")	20 (3/4")	25 (1")	32 (1 1/4")	40 (1 1/2")	50 (2")
L	mm	145-165-190	190	260	260	300	300
l	mm	225-245-270	290	360	380	440	460
H	mm	109	111	117	117	153	172
B	mm	100	100	104	104	126	160
D <sup>Filettatura</sup> Threading	mm	3/4"	1"	1"1/4	1"1/2	2"	2"1/2
Pesi Weight	kg	1,18	1,40	2,09	2,18	4,38	4,46
		1,41					9,40

Filettatura - Threading EN ISO 228-1:2000

I contatori DN 50 possono essere forniti flangiati secondo ISO 7005-2 / EN 1092-2 PN16  
The DN50 meters can be supplied flanged according to ISO 7005-2 / EN 1092-2 PN16

### Versione base - Basic version

- » MID R100-H 2004/22/CE
- » Disponibile in versione per acqua fredda 0°C-50°C e per acqua calda 30°C-90°C omologata MID R50 2004/22/CE
- » Trasmissione magnetica
- » Lettura diretta su 5 rulli numeratori (6 rulli numeratori su DN40 e DN50)
- » Quadrante asciutto
- » Coperchio girevole a 360°
- » MID R100-H 2004/22/CE
- » Available for cold water 0°C-50°C and for hot water 30°C-90°C MID R50 2004/22/CE approved
- » Magnetic transmission
- » Direct reading on 5 numeric rolls (6 numeric rolls on DN40 and DN50)
- » Dry dial
- » 360° rotating lid

### Su richiesta - Upon request

- » MID R160-H 2004/22/CE
- » Predisposizione per montaggio sistema lancia-impulsi
- » Equipaggiato con sistema lancia-impulsi
- » Protezione anti frode magnetica
- » MID R160-H 2004/22/CE
- » Prearranged for pulse emitter device mounting
- » Equipped with pulse emitter device
- » Anti-magnetic fraud protection

